

# CONVERGENCE CENTRE

**LEVEL 4**  
Faculty Offices  
Algoma University Biology Labs  
Lecture Room  
Computer Lab  
Lounge

**LEVEL 3**  
Faculty Offices  
Algoma University Biology Labs  
Lab Coordinator  
Lecture Theatre

**LEVEL 2**  
Administrative Offices  
Research and Innovation EL Hub  
Lecture Theatres  
Meeting Room

**LEVEL 1**  
Visual Arts Studios  
Faculty Offices  
Plant Department  
Research Support Labs



LEVEL 4



LEVEL 3

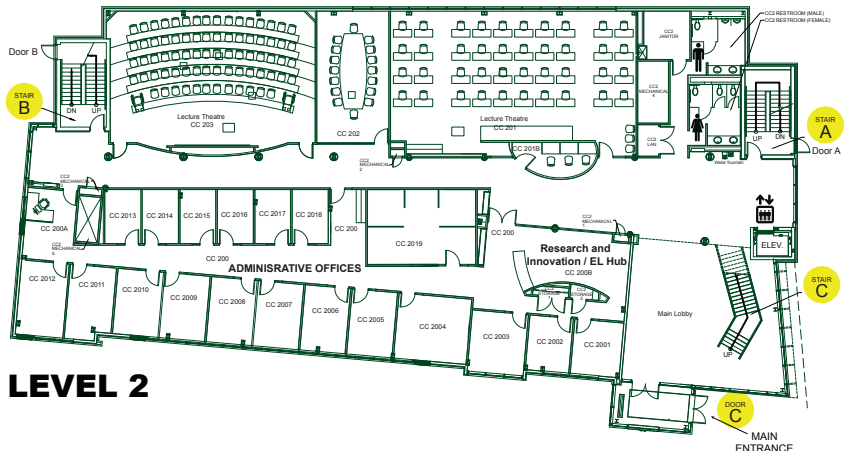

LEVEL 2



LEVEL 1

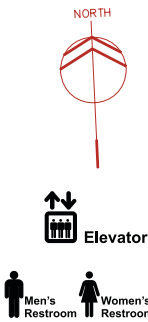

## MAP

### SAULT STE. MARIE CAMPUS

#### FALL 2021 NOTES

- Campus Bookstore temporarily relocated to the Library (WW)
- Algoma University Student Union (AUSU) offices temporarily relocated to Spirit Village Townhouse #10 (SV)
- Access to main building through doors G, Q, R, U and Z
- COVID-19 screeners at CC entrance (Door C) and main building Doors U and Z

#### REMINDER

The Sault Ste. Marie campus is a  
Smoke-free campus

- SH Shingwauk Hall  
NW North Wing  
WW West Wing (Arthur Wishart Library)  
FA Fire Arbour  
SV Spirit Village Townhouses  
AD Algoma Dormitory  
EW East Wing  
GLC George Leach Centre  
FC Bishop Fauquier Memorial Chapel  
SE Speakeasy  
CC Convergence Centre

#### CAMPUS LOCATIONS

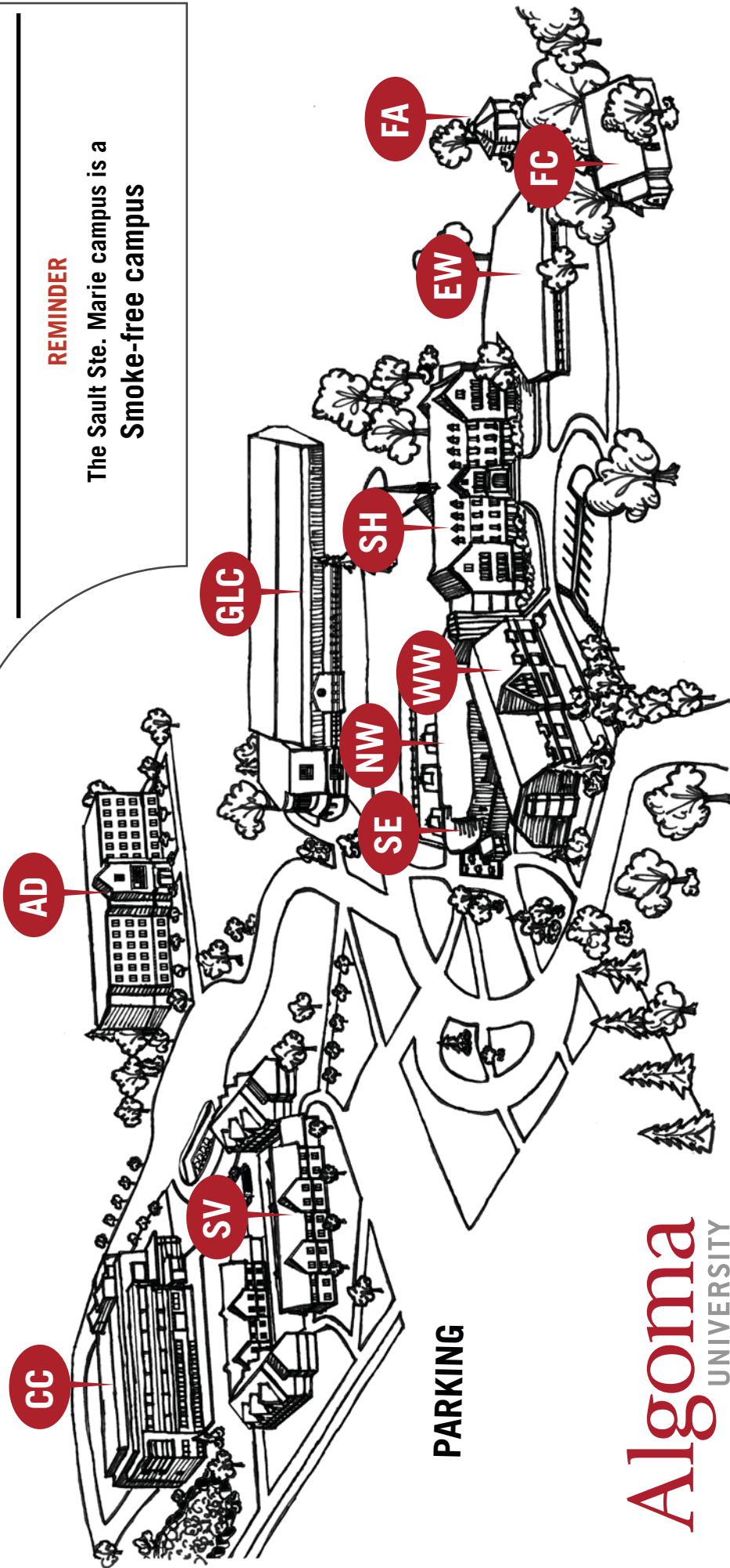

**Classrooms**  
**Department of Geography & Geology Faculty**  
**Department of Psychology Faculty**  
**School of Social Work Faculty**  
**Department of Sociology Faculty**  
**School of Business & Economics Faculty**

**Classrooms**  
**Department of Community, Economic & Social Development (CESD) Faculty**  
**Department of English Faculty**  
**Department of History Faculty**  
**Department of Law and Politics Faculty**  
**Department of Modern Languages Faculty**  
**Department of Psychology Faculty**  
**Staff/Faculty Mailroom**

Shingwauk Auditorium  
Recruitment - Campus Tours and Information  
Anishinaabe Student Life Center/  
Shingwauk Anishinaabe Students' Association  
Anishinaabe Initiatives Division  
Alumni & Advancement Office  
Office of the President  
Marketing & Communications

**Student Success Central**  
**Registration/Admissions/Financial Aid**  
**Cashier**  
**Provost & Academic Dean**  
**Registrar**  
**Learning Centre/Accessibility Services**  
**Information Technology Services**  
**School of Business & Economics Faculty**

**Circulation**  
**Helpdesk**  
**Campus Bookstore/Shop**

- International Student Support/ESL
- The Globe/Food Pantry
- Study Abroad
- Experiential Learning Hub
- E-Learning
- NORDIK Institute
- Health Services
- Physical Plant

- Security
- Great-West Life Amphitheatre
- Computer Labs
- Tim Hortons
- Cafeteria
- SpeakEasy

Classrooms  
Shingwauk Residential Schools Centre  
Doc Brown Lounge

**Computer and Gaming Labs**  
**Student Lounge**

Classrooms  
Prayer and Meditation Room  
School of Computer Science  
& Technology/Mathematics Faculty  
Sessional Faculty Offices  
Robert Ewing Geography & Akii Stewardship Lab  
Library Special Collections Archives & Rare Books

